

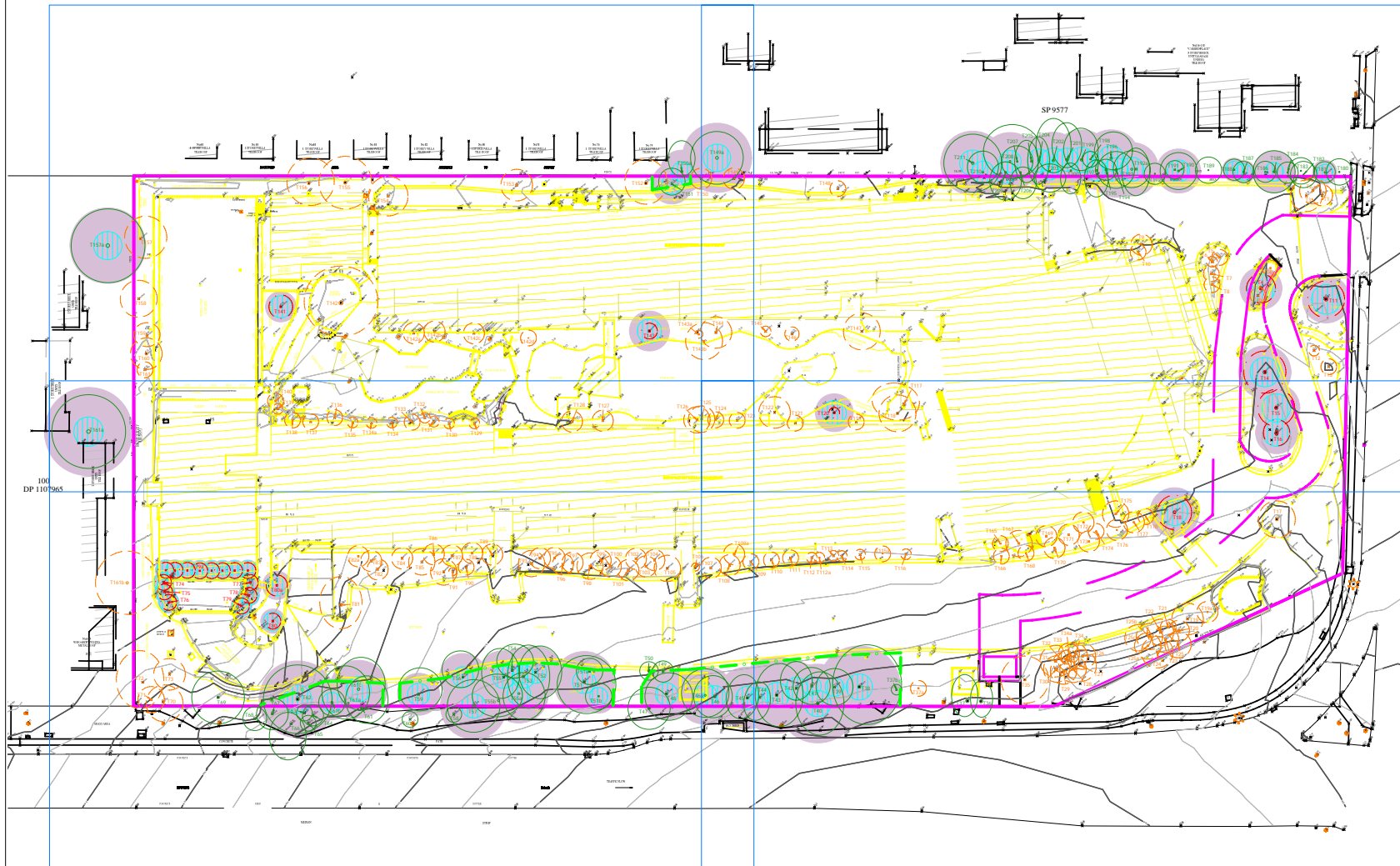

SHEET 4

SHEET 1





LEGEND

 Tree to be retained and protected in accordance with Tree Management Plan



 Tree to be removed in accordance with Section 13.16

 Tree to be pruned in accordance with Section 13.21

 Consider for transplanting elsewhere within the site - refer landscape plan

 Tree Protection Fence to be erected in accordance with Section 13.10

 Existing buildings & structures to be demolished. Demolition works within TPZ's to be undertaken in accordance with Section 13.18

 Structural Root Zone (SRZ)
 Tree Protection Zone (TPZ)

SHEET 3

SHEET 2

APPENDIX 6
TREE PROTECTION PLAN
DEMOLITION PHASE
 Macquarie Village
 110-114 Herring Road, MACQUARIE PARK



Earthscape Horticultural Services
 Arboricultural and Horticultural Consultants
 PO Box 364
 BEROWRA NSW 2081
 Ph: 02 9456 4787
 Fax: 02 9456 5757 e: earthscape@inet.net.au

Based on the Survey Drawing
 prepared by Denny Linker & Co.
 Dwg Ref No. 100915
 Dated 13/10/2010



DWG No. TLP 10-3511 KEY PLAN

DATE:03/02/2011