



18/08/11

landscape architecture  
environmental planning  
urban design  
public art

# habitation

## logos, kemps creek logistics project

Rev A Drawing: 10\_066 L000

T: (02) 9360 7771  
www.habitation.com.au  
ABN: 49 060 492 643  
Studio 25, 13-29 Nichols St,  
Surry Hills, NSW 2010

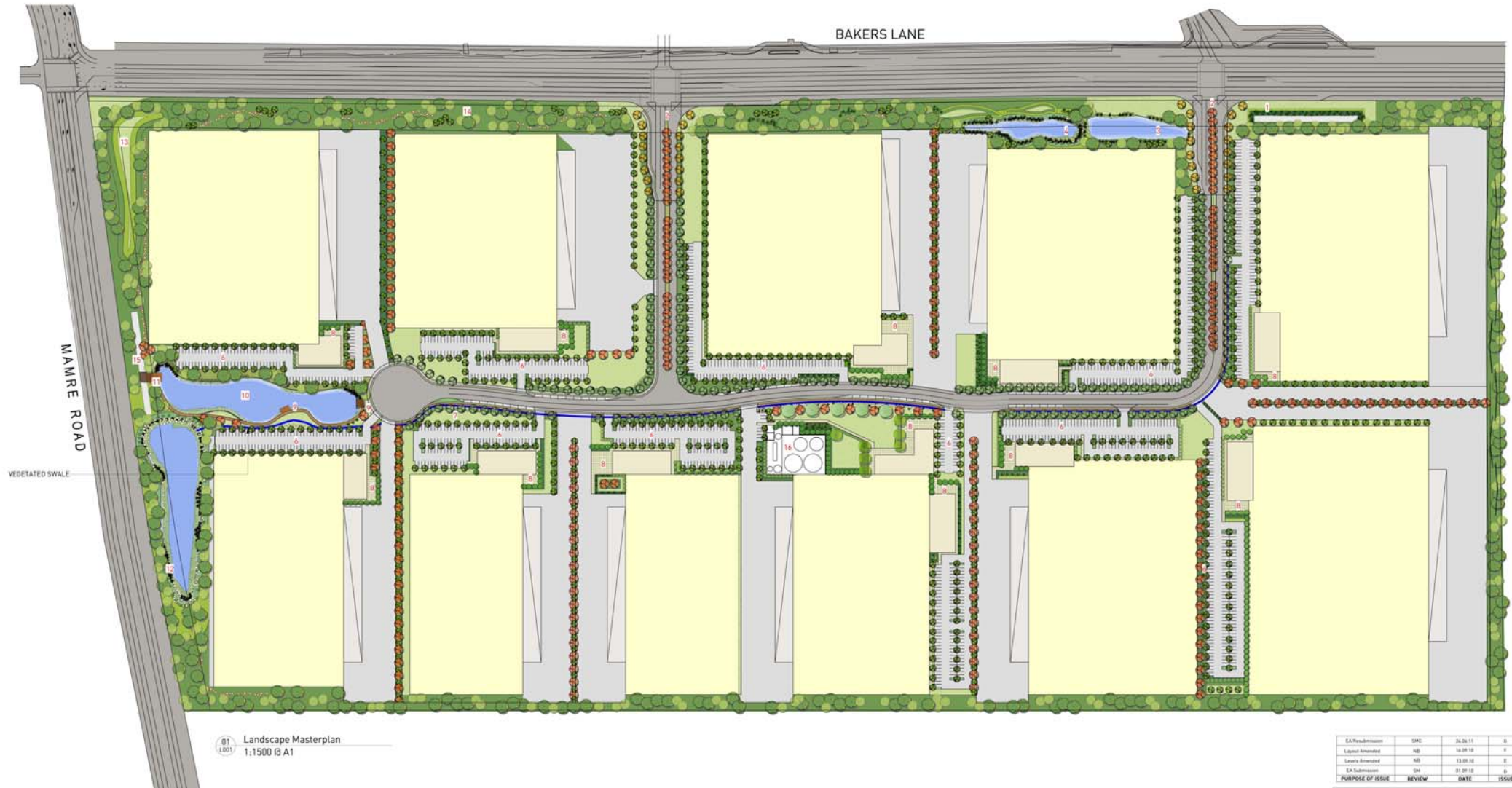

01 Landscape Masterplan  
1:1500 @ A1

#### DESIGN NOTES

##### 1. Concrete Rainwater tank structure, "Sustainability Marker Icons"

- Structure to be 1.5m above ground level and form a feature wall to the development.
- Concrete to be treated with patterns referencing the site's history, context and environmental values.
- Possible estate signage incorporated into wall.

##### 2. Entry Avenue

- Central row of colourful exotic flowering canopy trees to define entry

##### 3. Effluent Treatment Pond

- Pond split into an ephemeral area that fills in rain events and a deeper section that will have permanent water body forming an entry feature to the development.
- Possible gabion wall surrounds the pond with macrophytic plants, reeds and rushes to the edges.
- Pond collects tertiary treated water from the on site sewerage plant. Water from the ponds is used to irrigate the surrounding landscape.

##### 4. OSD Basin

- The OSD basin takes overflow from the Effluent treatment pond and all overland flow run off. The basin is mostly dry and contains macrophytic plants to help with water quality and to create an aesthetically interesting natural feature in the landscape.
- Basin shall contain some rockwork at inlets and outlet points.
- Banks of the basin are planted with native grasses, shrubs and large trees to the tops of the embankments.

##### 5. Recreation Area

- Open grassed space for passive and active recreation
- Outdoor covered eating areas around café and gym buildings
- Feature row of shade trees defining space and providing separation from access road.

##### 6. Carparks

- Carparking bays with canopy shade trees and underplanting.

##### 7. Bio-Swale and Boardwalk

- Run off from pavements and landscape shall be directed into a bio-swale that will flow into the OSD basin.
- The swale shall be 3m wide with a 1m flat bottom and water couch planted to the base. The sides of the swale shall be planted with *Lomandra longifolia*.
- A 1.5m wide timber/mesh or similar boardwalk shall follow the swale and provide the main pedestrian access network for the site and link the commercial buildings and offices to the recreation areas and ponds.

##### 8. Outdoor Staff areas

##### 9. Viewing Platforms and Seating around Ponds

##### 10. Tertiary Effluent Treatment Storage Pond

##### 11. Viewing platform/Gazebo structure

##### 12. OSD basin

##### 13. Feature Planting on landscape mound to major intersection

##### 14. Native Vegetation Buffer Zone.

- Stepped boulder retaining walls
- Drainage Swale
- Native tree, shrubs and grass planting.

##### 15. Concrete Rainwater tank structure, "Sustainability Marker Icons"

- Structure to be 0.5m above ground level and form a feature wall to the development.
- Concrete to be treated with patterns referencing the site's history, context and environmental values.
- Possible estate signage incorporated into wall

##### 16. Sewerage Treatment Plant

- Incorporate "Green Wall" around external edge of treatment plant
- Screen select areas with small native canopy trees

EA Resubmission	SMC	26 Dec 11	B
Landscape Amendment	NB	16 Dec 10	A
Landscape Amendment	NB	13 Dec 10	E
EA Submission	SM	31 Dec 10	D
PURPOSE OF ISSUE	REVIEW	DATE	ISSUE

#### LOGOS, KEMPS CREEK LOGISTICS PROJECT

PROJECT ADDRESS	MAMRE RD AND BAKERS LANE, ERSKINE PARK, NSW
DRAWING TITLE	LANDSCAPE MASTERPLAN
ORIGINAL MEDIA SIZE	1:1500 @ A1
PLOT TIME	18/06/11
STATUS	0
landscape architecture environmental planning urban design public art	

**habitation**

David Vago Pty Ltd trading as:  
Habitation  
Studio 25, 13-29 Nichols St, Surry Hills,  
NSW 2010  
T: (02) 9360 7771  
E: studio@habitation.com.au  
www.habitation.com.au  
ABN: 49 060 472 843

Landscape Architect's work is subject to Copyright. Documents should not be used without the permission of the owner without written permission from Habitation.

NEVER scale off drawings, use figured dimensions only. Drawings indicate scope of works and general intent. These are not shop drawings.

10\_066 L001





PLATFORM/VIEWING DECK WITH OVERHEAD SHADE STRUCTURE

TIMBER BOARDWALK TO WRAP AROUND BASIN EDGE

GATE AND ACCESS ROAD

OFFICE COURTYARDS

#### LEGEND

- Carpark Trees
- Street Trees
- Feature Trees
- Entry Trees
- Cumberland Plain Woodland Planting

INDICATIVE PLANT SCHEDULE					
SPECIES	COMMON NAME	HIGHT x SPRD	SPACINGS	POT SIZE	
ESTATE PLANTING					
Trees					
EM	Eucalyptus melucana	Grey Box	20m x 15m	As shown	45L
ESR	Eucalyptus 'Summer Red'	Flowering Gum	15m x 10m	As shown	45L
FG	Fraxinus griffithii	Evergreen Ash	8m x 5m	As shown	45L
TL	Tristanopsis laurina	Water Gum	8m x 5m	As shown	45L
WF	Waterhousea floribunda	Weeping Lily Pili	15m x 10m	As shown	45L
Hedges					
ASM	Acmena smithii minor	Lily Pili	3m x 2m	2m	200mm
CL	Callistemon linearis	Bottlebrush	2m x 2m	2m	200mm
SLBR	Syzygium leuhammii 'Big Red'	Lily Pili	5m x 3m	2m	200mm
Shrubs					
BS	Banksia spinulosa	Hairpin Banksia	2m x 2m	1m	200mm
CCC	Callistemon 'Captain Cook'	Bottlebrush	1m x 1m	1m	200mm
CR	Correa reflexa	Native Fuschia	2m x 2m	1m	200mm
DE	Doryanthes excelsa	Gymea Lily	2m x 2m	1m	200mm
GRG	Grevillea 'Robyn Gordon'	Grevillea	1m x 1m	1m	200mm
WF	Westringia fruticosa	Native Rosemary	2m x 2m	1m	200mm
Groundcovers					
BSC	Billardiera scandens	Apple Berry	0.3m x 2m	400mm	150mm
DR	Dianella revoluta	Paroo Lily	0.6m 0.6m	400mm	150mm
HV	Hardenbergia violacea	False Sarsparilla	0.3m x 2m	400mm	150mm
HS	Hibbertia scandens	Snake Vine	0.3m x 2m	400mm	150mm
LF	Lomandra fluviatilis	Mat Rush	0.6m 0.6m	400mm	150mm
LL	Lomandra longifolia	Mat Rush	0.6m 0.6m	400mm	150mm
CUMBERLAND PLAIN WOODLAND PLANTING					
Trees					
CM	Corymbia maculata	Spotted Gum	20m x 15m	As shown	45L
EC	Eucalyptus ombra	Narrow Leaved Ironbark	20m x 15m	As shown	45L
EM	Eucalyptus melucana	Grey Box	20m x 15m	As shown	45L
ET	Eucalyptus tereticornis	Forest Red Gum	20m x 15m	As shown	45L
Shrubs					
AD	Acacia decurrens	Black Wattle	3m x 3m	1m	tube
AI	Acacia implexa	Hickory Wattle	3m x 3m	1m	tube
BSP	Bursaria spinosa	Blackthorn	2m x 2m	1m	tube
DS	Dillwynia sieberi	Prickly Parrot Pea	2m x 2m	1m	tube
IA	Indigofera australis	Austral Indigo	2m x 2m	1m	tube
MD	Melaleuca decora	Whiote Feather Honey	5m x 3m	1m	tube
Groundcovers					
DR	Dianella revoluta	Paroo Lily	0.6m x 0.6m	400mm	tube
DRE	Dichondra repens	Kidney Weed	0.3m x 2m	400mm	tube
EMA	Entolasia marginata	Right Angle Grass	0.6m x 0.6m	400mm	tube
HV	Hardenbergia violacea	False Sarsparilla	0.3m x 2m	400mm	tube
LM	Lomandra multiflora	Mat Rush	0.6m x 0.6m	400mm	tube
MS	Microlaena stipoides	Weeping Grass	0.6m x 0.6m	400mm	tube
PP	Pratia purpurascens	White Root	0.3m x 2m	400mm	tube
TA	Themeda australis	Kangaroo Grass	0.6m x 0.6m	400mm	tube
DETENTION BASIN / WETLAND PLANTING					
Trees / Shrubs					
AD	Acacia decurrens	Black Wattle	3m x 3m	1m	tube
MD	Melaleuca decora	Whiote Feather Honey	5m x 3m	1m	tube
Groundcovers					
CO	Cyperus gunnii	Cyperus	0.6m x 0.6m	400mm	tube
DR	Dianella revoluta	Paroo Lily	0.6m x 0.6m	400mm	tube
ES	Eleocharis sphacelata	Spike Rush	1.5 x 1m	400mm	tube
JU	Juncus usitatus	Common Rush	0.6m x 0.6m	400mm	tube
LM	Lomandra multiflora	Mat Rush	0.6m x 0.6m	400mm	tube
PD	Pennisetia decipiens	Slender Knotweed	0.6m x 0.6m	400mm	tube
TO	Typha orientalis	Reed	1.5 x 1m	400mm	tube

- Pavement
- Mass Planting
- Turf
- Rocks
- Landscape Retaining Walls
- Reeds
- Grasses
- Feature Shrubs <1m
- Feature Shrubs >1m
- Hedge
- Screening Shrub

EA Resubmission	SAC	20.04.11	0
Lapsed Amendment	NB	14.04.10	7
Locality Amendment	NB	10.04.10	5
EA Submission	SM	01.04.10	0

PURPOSE OF ISSUE	REVIEW	DATE	ISSUE
------------------	--------	------	-------

LOGOS, KEMPS CREEK LOGISTICS PROJECT

PROJECT ADDRESS: MAHRE RD AND BAKERS LANE, ERSKINE PARK, NSW

DRAWING TITLE: DETAIL PLAN

ORIGINAL MEDIA SIZE: 1:500 @ A1

STATUS: 0

landscape architecture

environmental planning

urban design

public art

habitation

Habitation Studio 25, 13-29 Nichols St, Surry Hills, NSW 2010

T: (02) 9240 7771

www.habitation.com.au

ADN: 47 540 472 442

Landscape Architect's work is subject to Copyright. Documents should not be used contrary to the purpose of the issue without written permission from Habitation.

NEVER scale off drawings, use figure dimensions only. Drawings indicate scope of works and general intent. These are not shop drawings.

01 Landscape Plan- OSD Basin  
1:500 @ A1

#### ESTATE PLANTING



#### PRECEDENT IMAGES



10\_066 L002





01 Cafe Precinct-Landscape Plan  
1:200 @ A1

#### ESTATE PLANTING



#### PRECEDENT IMAGES



TIMBER BOARDWALK TO RUN PARALLEL TO ROAD EDGE (1.5M WIDE)  
VEGETATED SWALE TO A MAX OF 3M WIDE

MASS PLANTING UNDER TREE CANOPY

ROW OF DECIDUOUS TREES TO SHADE CAFE AREA

OPENING TO GRASS AREA

SEATING

#### LEGEND

- Carpark Trees
- Street Trees
- Feature Trees
- Entry Trees
- Cumberland Plain Woodland Planting
- Swale
- Pavement
- Mass Planting
- Turf
- Rocks
- Landscape Retaining Walls
- Reeds
- Grasses
- Feature Shrubs <1m
- Feature Shrubs >1m
- Hedge
- Screening Shrub

EA Resubmission	10/01	24.06.11	01
Landscape Amendment	01/01	14.09.10	01
Levels Amendment	01/01	10.09.10	01
EA Submission	01/01	01.09.10	01

#### LODGS, KEMPS CREEK LOGISTICS PROJECT

PROJECT ADDRESS: HAMRE RD AND BAKERS LANE, ERSKINE PARK, NSW

DRAWING TITLE: DETAIL PLAN

ORIGINAL MEDIA SIZE: 1,000 @ A1

PLOT TIME: 18/09/11

STATUS: 0

landscape architecture  
environmental planning  
urban design  
public art

habitation

Habitation  
Studio 25, 13-29 Nichols St, Surry Hills,  
NSW 2010  
T: (02) 9360 7771  
www.habitation.com.au  
ABN: 49 040 492 643

Landscape Architect's work is subject to Copyright. Documents should not be used contrary to the purpose of the issue without written permission from Habitation.  
NEVER scale off drawings, use figured dimensions only. Drawings indicate scope of works and general setting. These are not shop drawings.

10\_066 L003



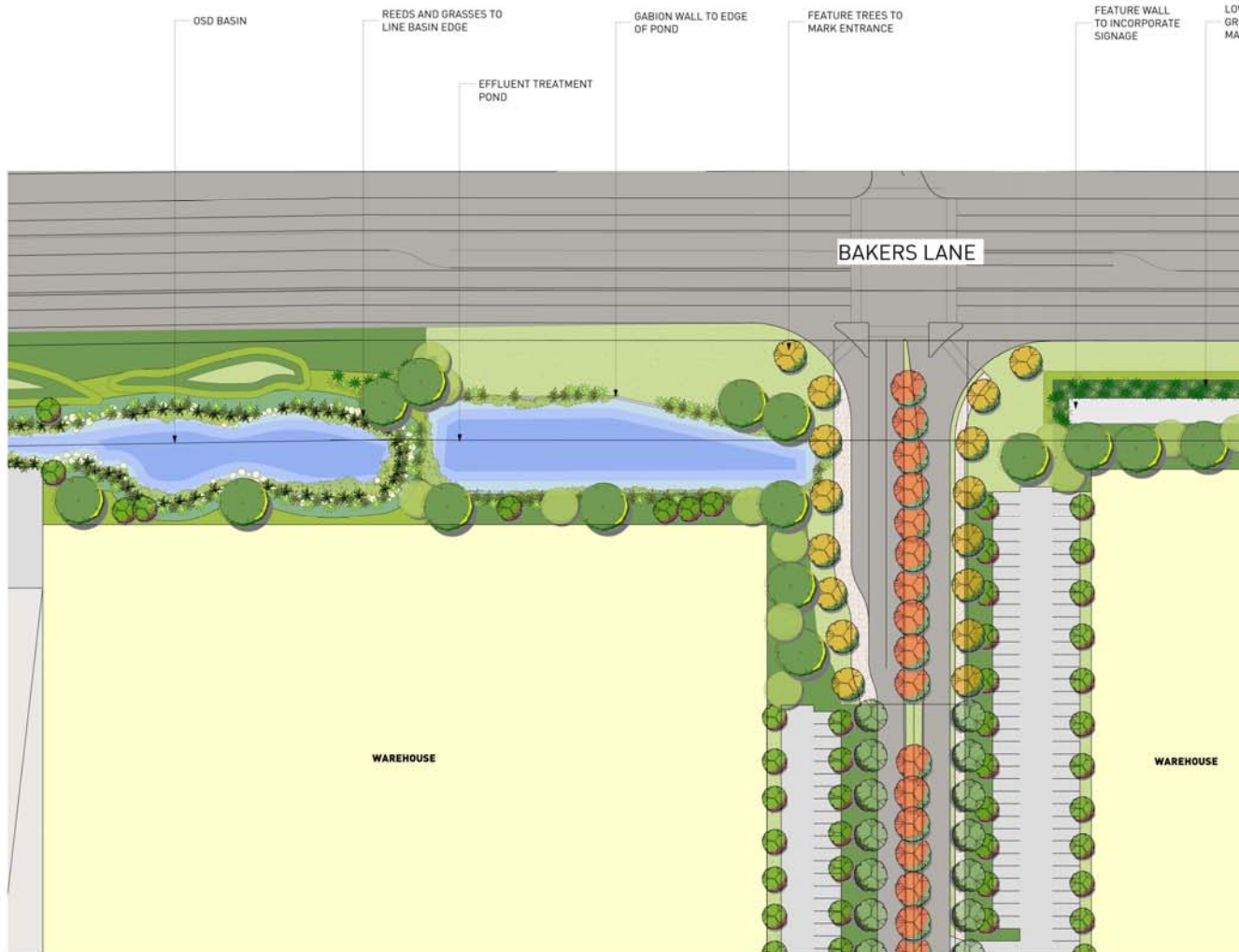

01 Landscape Plan- Bakers Lane Entry  
1:500 @ A1

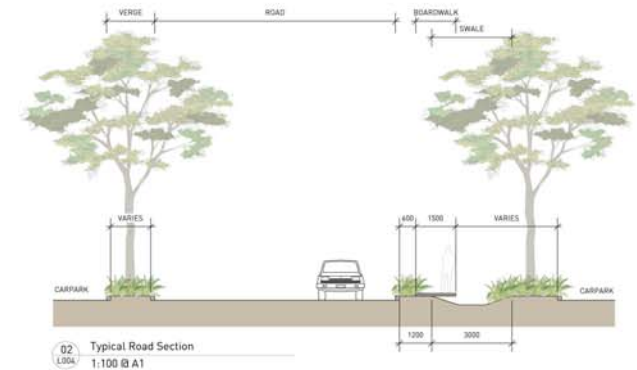

02 Typical Road Section  
1:100 @ A1

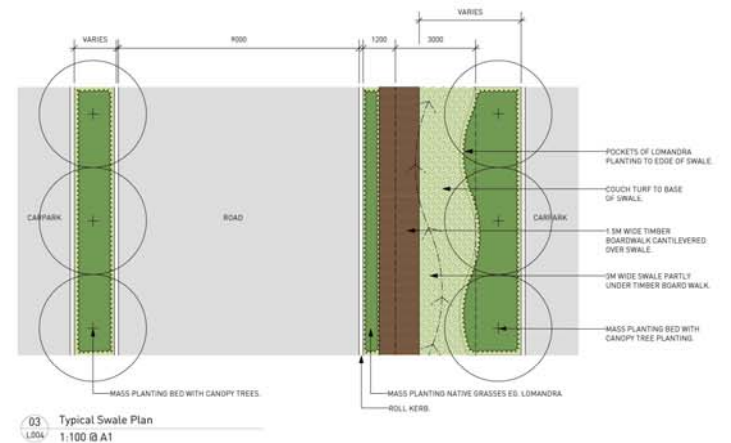

03 Typical Swale Plan  
1:100 @ A1

#### LEGEND



Carpark Trees  
Street Trees  
Feature Trees  
Entry Trees  
Cumberland Plain Woodland Planting



Pavement  
Mass Planting  
Turf  
Rocks  
Landscape Retaining Walls  
Reeds  
Grasses  
Feature Shrubs <1m  
Feature Shrubs >1m  
Hedge  
Screening Shrub

#### PRECEDENT IMAGES



EA Road/Drainage	SMC	24.04.11	0
Landscape Architect	NS	16.09.10	F
Landscape Architect	NS	15.04.10	B
EA Submissions	SM	01.09.10	10

PURPOSE OF ISSUE REVIEW DATE ISSUE

LOGOS, KEMPS CREEK LOGISTICS PROJECT

PROJECT ADDRESS: MANRE RD AND BAKERS LANE, ERSKINE PARK, NSW

DRAWING TITLE: DETAIL PLAN

ORIGINAL MEDIA SIZE: 1,200 @ A1

PLOT TIME: 16/06/11

STATUS: 0

landscape architecture  
environmental planning  
urban design  
public art

habitation

Habitation  
Studio 25, 13-29 Nichols St, Surry Hills, NSW 2010  
T: (02) 9360 7771  
www.habitation.com.au  
ABN: 47 060 472 643

Landscape Architect's work is subject to Copyright. Documents should not be used contrary to the purpose of the issue without written permission from Habitation.  
NEVER scale off drawings, use figure dimensions only. Drawings indicate scope of work and general intent. These are not shop drawings.

10\_066 L004

